

GEC...XS,XS-2RS

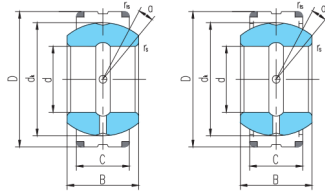

滑动摩擦副：钢 / 钢
Sliding contact surfaces: Steel / Steel



GEC...XS

GEC...XS-2RS

select	Inquiry	Bearing number	Overall dimension [mm]									Rated load [kN]		Weight kg
			d	D	B	C	d _k	r _s min	r _{1s} min	a°	live load	Static load		
GEC320XS	GEC320XS-2RS	320	440	160	135	380	1.1	3	4	4400	22000	78		
GEC340XS	GEC340XS-2RS	340	460	160	135	400	1.1	3	3	4650	23200	83		
GEC360XS	GEC360XS-2RS	360	480	160	135	420	1.1	3	3	4800	24000	87		
GEC380XS	GEC380XS-2RS	380	520	190	160	450	1.5	4	4	6300	31500	129		
GEC400XS	GEC400XS-2RS	400	540	190	160	470	1.5	4	3	6550	32500	135		
GEC420XS	GEC420XS-2RS	420	560	190	160	490	1.5	4	3	6800	34500	141		
GEC440XS	GEC440XS-2RS	440	600	218	185	520	1.5	4	3	8650	42300	196		
GEC460XS	GEC460XS-2RS	460	620	218	185	540	1.5	4	3	9000	45000	204		