

SI...C,ET-2RS

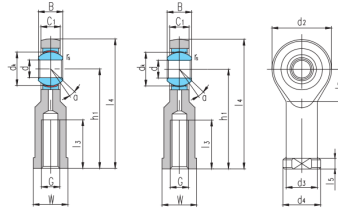

滑动摩擦副: 钢 / PTFE 复合材料($d \leq 30$)
钢 / PTFE 编织物 ($d \geq 15$)



SI...C

SI...ET-2RS

| select | Inquiry | Bearing number | Dimension mm | | | | | | | | | | | | | | | | load rating kN | | Weight kg |
|------------|---------|----------------|--------------|------|-----|--------------------|----------------|------|----------------|--------------------|----------------|----------------|----------------|-----|----------------|----------------|--------|------|----------------|-------------|-----------|
| | | | d | B | dk | C ₁ max | d ₂ | G 6H | h ₁ | l ₃ min | l ₄ | l ₅ | l ₇ | W | d ₃ | d ₄ | rs min | a° | dynamic load | static load | |
| SI5C | 5 | 6 | 10 | 4.5 | 21 | M5 | 30 | 11 | 40.5 | 5 | 11.5 | 10 | 10 | 13 | 0.3 | 13 | 3.6 | 8.1 | 0.021 | | |
| SI6C | 6 | 6 | 10 | 4.5 | 21 | M6 | 30 | 11 | 40.5 | 5 | 11.5 | 11 | 11 | 13 | 0.3 | 13 | 3.6 | 8.1 | 0.021 | | |
| SI8C | 8 | 8 | 13 | 6.5 | 24 | M8 | 36 | 15 | 48 | 5 | 13 | 13 | 13 | 16 | 0.3 | 15 | 5.8 | 12.9 | 0.039 | | |
| SI10C | 10 | 9 | 16 | 7.5 | 29 | M10 | 43 | 20 | 57.5 | 6.5 | 15 | 16 | 16 | 19 | 0.3 | 12 | 8.6 | 17.6 | 0.065 | | |
| SI12C | 12 | 10 | 18 | 8.5 | 34 | M12 | 50 | 23 | 67 | 7 | 18 | 18 | 19 | 22 | 0.3 | 10 | 11 | 24.5 | 0.096 | | |
| SI15C | 15 | 12 | 22 | 10.5 | 40 | M14 | 61 | 30 | 81 | 8 | 21 | 21 | 21 | 26 | 0.3 | S | 18 | 36 | 0.16 | | |
| SI15ET-2RS | 15 | 12 | 22 | 10.5 | 40 | M14 | 61 | 30 | 81 | 8 | 21 | 21 | 21 | 26 | 0.3 | 8 | 25 | 36 | 0.16 | | |
| SI17C | 17 | 14 | 25 | 11.5 | 46 | M16 | 67 | 34 | 90 | 10 | 24 | 27 | 25 | 29 | 0.3 | 10 | 22 | 45 | 0.24 | | |
| SI17ET-2RS | 17 | 14 | 25 | 11.5 | 46 | M16 | 67 | 34 | 90 | 10 | 24 | 27 | 25 | 29 | 0.3 | 10 | 32 | 45 | 0.24 | | |
| SI20C | 20 | 16 | 29 | 13.5 | 53 | M20x1.5 | 77 | 40 | 103.5 | 10 | 25.5 | 30 | 28 | 34 | 0.3 | 9 | 31 | 60 | 0.35 | | |
| SI20ET-2RS | 20 | 16 | 29 | 13.5 | 53 | M20x1.5 | 77 | 40 | 103.5 | 10 | 25.5 | 30 | 28 | 34 | 0.3 | 9 | 45 | 60 | 0.35 | | |
| SI25C | 25 | 20 | 35.5 | 18 | 64 | M24x2 | 94 | 48 | 126 | 12 | 33 | 36 | 35 | 42 | 0.6 | 7 | 51 | 83 | 0.66 | | |
| SI25ET-2RS | 25 | 20 | 35.5 | 18 | 64 | M24x2 | 94 | 48 | 126 | 12 | 33 | 36 | 35 | 42 | 0.6 | 7 | 85 | 83 | 0.66 | | |
| SI30C | 30 | 22 | 40.7 | 20 | 73 | M30x2 | 110 | 56 | 146.5 | 15 | 37.5 | 46 | 42 | 50 | 0.6 | 6 | 65 | 110 | 0.98 | | |
| SI30ET-2RS | 30 | 22 | 40.7 | 20 | 73 | M30x1.5 | 110 | 56 | 146.5 | 15 | 37.5 | 46 | 42 | 50 | 0.6 | 6 | 110 | 110 | 0.98 | | |
| SI35ET-2RS | 35 | 25 | 47 | 22 | 82 | M36x3 | 125 | 60 | 166 | 15 | 40 | 55 | 48 | 58 | 0.6 | 6 | 140 | 146 | 1.5 | | |
| SI40ET-2RS | 40 | 28 | 53 | 24 | 92 | M39x3 | 142 | 65 | 188 | 18 | 47 | 60 | 52 | 65 | 0.6 | 7 | 175 | 180 | 2.1 | | |
| SI45ET-2RS | 45 | 32 | 60 | 28 | 102 | M42x3 | 145 | 65 | 196 | 20 | 52 | 65 | 58 | 70 | 0.6 | 7 | 225 | 240 | 2.7 | | |
| SI50ET-2RS | 50 | 35 | 66 | 31 | 112 | M45x3 | 160 | 68 | 216 | 20 | 57 | 70 | 62 | 75 | 0.6 | 6 | 275 | 290 | 3.5 | | |
| SI60ET-2RS | 60 | 44 | 80 | 39 | 135 | M52x3 | 175 | 70 | 242.5 | 20 | 68.5 | 80 | 70 | 88 | 1 | 6 | 430 | 450 | 5.6 | | |
| SI70ET-2RS | 70 | 49 | 92 | 43 | 160 | M56x4 | 200 | 80 | 280 | 20 | 81 | 85 | 80 | 98 | 1 | 6 | 550 | 610 | 8.3 | | |
| SI80ET-2RS | 80 | 55 | 105 | 48 | 180 | M64x4 | 230 | 85 | 320 | 25 | 91 | 95 | 95 | 110 | 1 | 6 | 705 | 750 | 13 | | |