

SA...C,ET-2RS

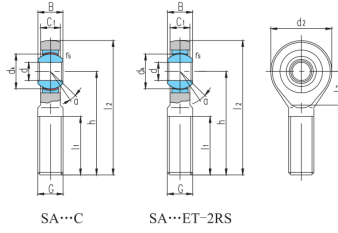

滑动摩擦副: 钢 / PTFE 复合材料($d \leq 30$)
 钢 / PTFE 编织物 ($d \geq 15$)



select	Inquiry	Bearing number	Dimension mm												load rating kN		Weight kg
			d	B	d _k	C ₁ max	d ₂	G 6g	h	l ₁ min	l ₂	l ₇	rs min	a°	dynamic load	static load	
SA5C	5	6	10	4.5	21	M5	36	16	46.5	11.5	0.3	13	3.6	3.9	0.017		
SA6C	6	6	10	4.5	21	M6	36	16	46.5	11.5	0.3	13	3.6	5.5	0.017		
SA8C	8	8	13	6.5	24	M8	42	21	54	13	0.3	15	5.8	10	0.029		
SA10C	10	9	16	7.5	29	M10	48	26	62.5	15.5	0.3	12	8.6	16	0.05		
SA12C	12	10	18	8.5	34	M12	54	28	71	18	0.3	10	11	23	0.066		
SA15C	15	12	22	10.5	40	M14	63	34	83	21	0.3	8	18	32	0.12		
SA15ET-2RS	15	12	22	10.5	40	M14	63	34	83	21	0.3	8	25	32	0.12		
SA17C	17	14	25	11.5	46	M16	69	36	92	24	0.3	10	22	44	0.19		
SA17ET-2RS	17	14	25	11.5	46	M16	69	36	92	24	0.3	10	32	44	0.19		
SA20C	20	16	29	13.5	53	M20x1.5	78	43	104.5	25.5	0.3	9	31	60	0.31		
SA20ET-2RS	20	16	29	13.5	53	M20×1.5	78	43	104.5	25.5	0.3	995	45	60	0.31		
SA25C	25	20	35.5	18	64	M24x2	94	53	126	31	0.6	7	51	83	0.56		
SA25ET-2RS	25	20	35.5	18	64	M24×2	94	53	126	31	0.6	7	85	83	0.56		
SA30C	30	22	40.7	20	73	M30x2	110	65	146.5	35.5	0.6	6	65	110	0.89		
SA30ET-2RS	30	22	40.7	20	73	M30×2	110	65	146.5	35.5	0.6	6	110	110	0.89		
SA35ET-2RS	35	25	47	22	82	M36x3	140	82	181	41	0.6	6	140	146	1.4		
SA40ET-2RS	40	28	53	24	92	M39x3	150	86	196	47	0.6	7	175	180	1.8		
SA45ET-2RS	45	32	60	28	102	M42x3	163	92	214	52	0.6	7	225	240	2.5		
SA50ET-2RS	50	35	66	31	112	M45x3	185	104	241	60	0.6	6	275	290	3.6		
SA60ET-2RS	60	44	80	39	135	M52x3	210	115	277.5	75.5	1	6	430	450	5.7		
SA70ET-2RS	70	49	92	43	160	M56x4	235	125	315	95	1	6	550	610	7.9		
SA80ET-2RS	80	55	105	48	180	M64x4	270	140	360	105.5	1	6	705	750	12		